

Radiator

Replacement

(Except Coupe)

WARNING

- System is under high pressure when engine is hot. To avoid danger of releasing scalding coolant, remove cap only when engine is cool.

Total Cooling System Capacity (Incl. heater, incl. reservoir tank):

See Specifications Section, page 3-3.

CAUTION: If any coolant spills on painted portions of the body, rinse it off immediately.

NOTE:

- Check all cooling system hoses for damage, leaks or deterioration and replace if necessary.
- Check all hose clamps and retighten if necessary.
- Use new O-ring whenever reassembling.

RADIATOR

Leak test, page 10-5

Refilling, page 10-4

Inspect soldered joints and seams for leaks.

Blow dirt out from between core fins with compressed air.

If insects, etc., are clogging radiator, wash them off with low pressure water

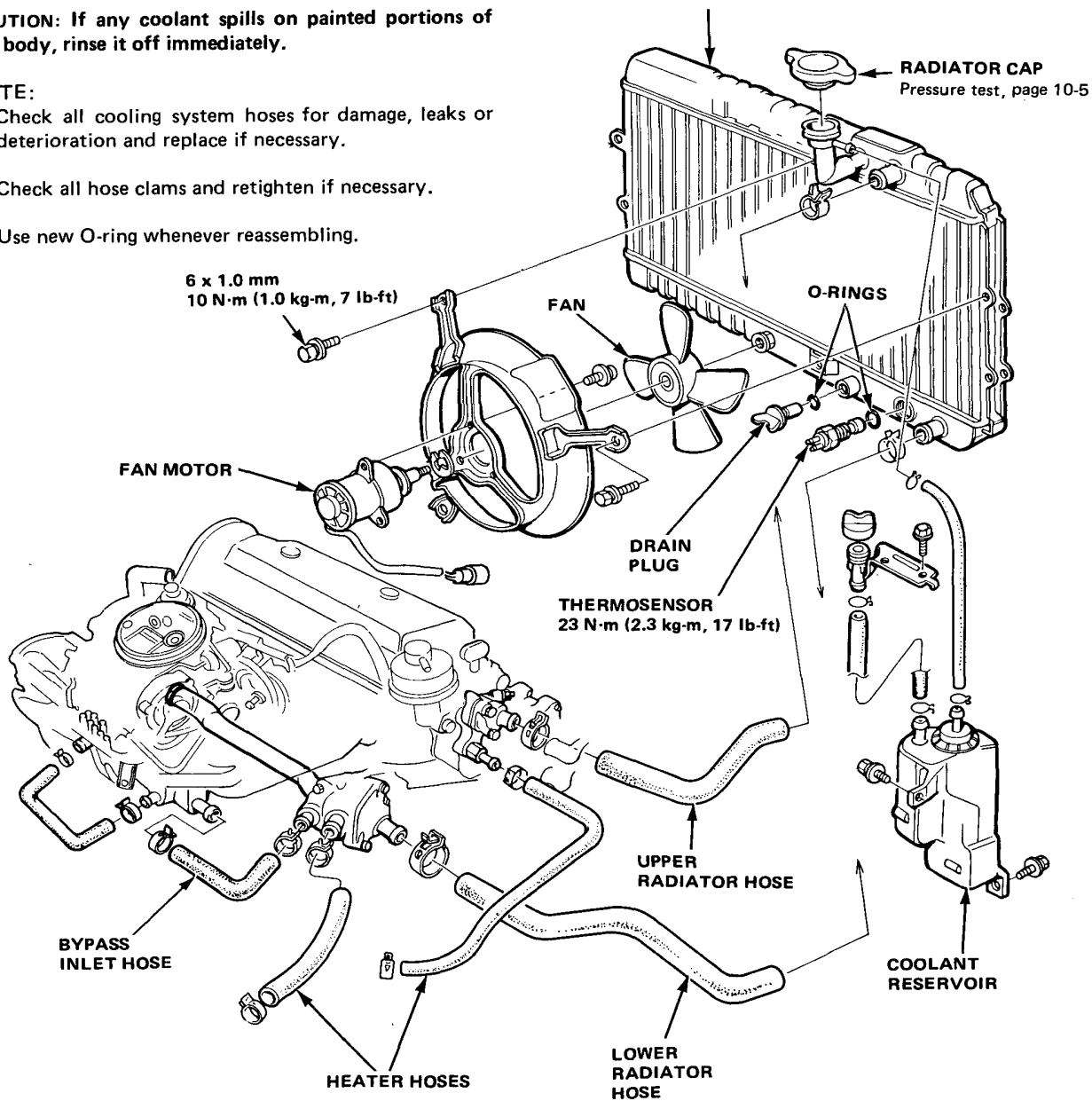



(Coupe)

WARNING

- System is under high pressure when engine is hot. To avoid danger of releasing scalding coolant, remove cap only when engine is cool.

Total Cooling System Capacity (Incl. heater, incl. reservoir tank): 5.1 liter (1.3 U.S. gal., 1.1 Imp. gal.)

CAUTION: If any coolant spills on painted portions of the body, rinse it off immediately.

NOTE:

- Check all cooling system hoses for damage, leaks or deterioration and replace if necessary.
- Check all hose clamps and retighten if necessary.
- Use new O-ring whenever reassembling.

RADIATOR

Leak test, page 10-5
Refilling, page 10-4
Inspect soldered joints and seams for leaks.
Blow dirt out from between core fins with compressed air.
If insects, etc., are clogging radiator, wash them off with low pressure water

RADIATOR CAP

Pressure test, page 10-5

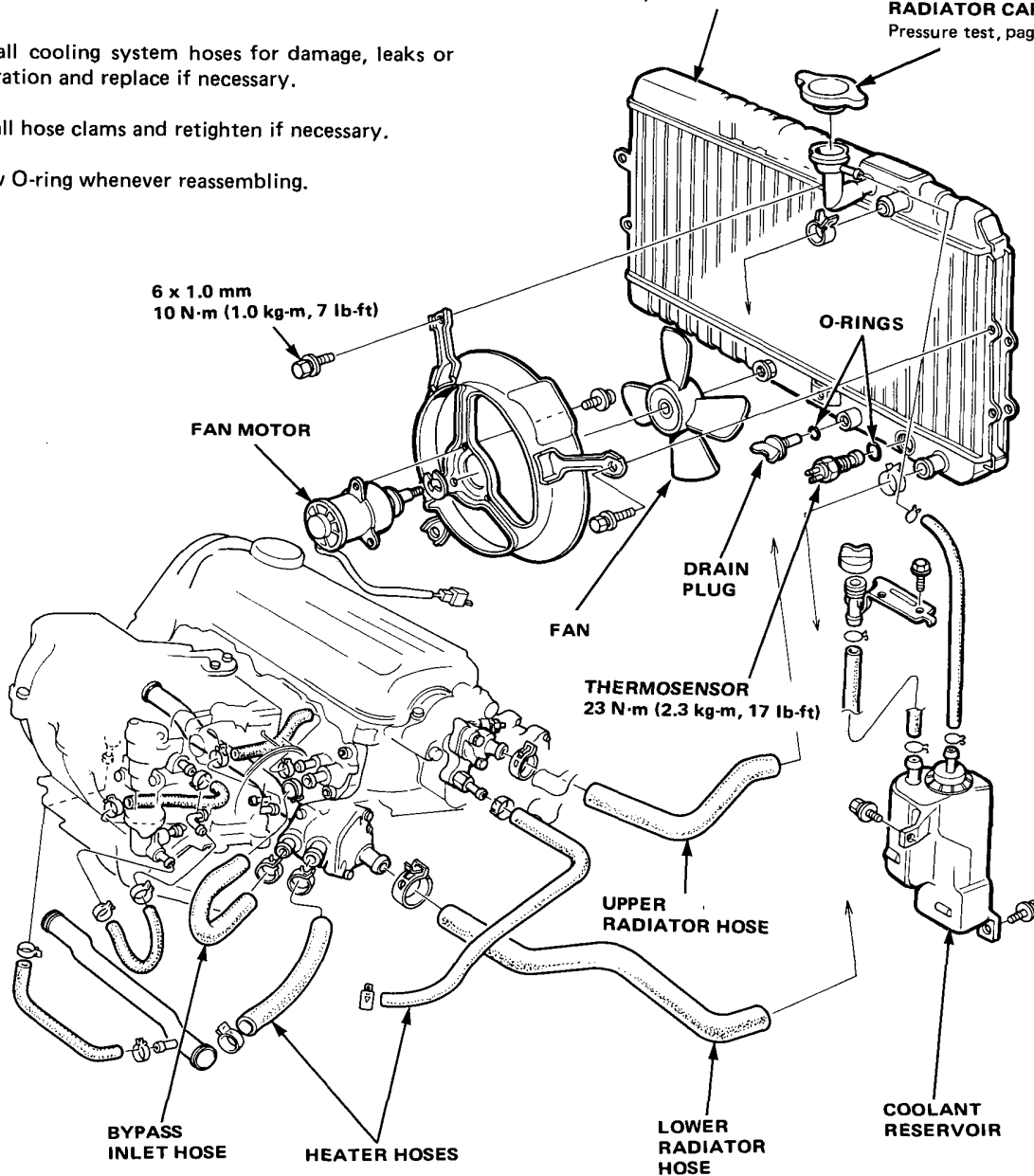

Radiator

Refilling and Bleeding

1. Set the heater temperature lever to maximum heat.
2. When the radiator is cool, remove the radiator cap and drain plug, and drain the radiator.
3. Reinstall the radiator drain plug and tighten it securely.
4. Remove, drain and reinstall the reserve tank. Fill the tank halfway to the MAX mark with water, then up to the MAX mark with coolant.
5. Mix the recommended anti-freeze with an equal amount of water, in a clean container.

NOTE:

- Use only HONDA-RECOMMENDED anti-freeze/coolant.
- For best corrosion protection, the coolant concentration must be maintained year-round at 50% MINIMUM. Coolant concentrations less than 50% may not provide sufficient protection against corrosion or freezing.
- Coolant concentrations greater than 60% will impair cooling efficiency and are not recommended.

CAUTION:

- Do not mix different brand anti-freeze/coolants.
- Do not use additional rust inhibitors or anti-rust products; they may not be compatible with the recommended coolant.

Radiator Coolant Refill Capacity (Incl. reserve tank): See Specifications Section, page 3-3.

6. Loosen the air bleed bolt in the water outlet, then fill the radiator to the bottom of the filler neck with the coolant mixture. Tighten the bleed bolt as soon as coolant starts to run out in a steady stream without bubbles.

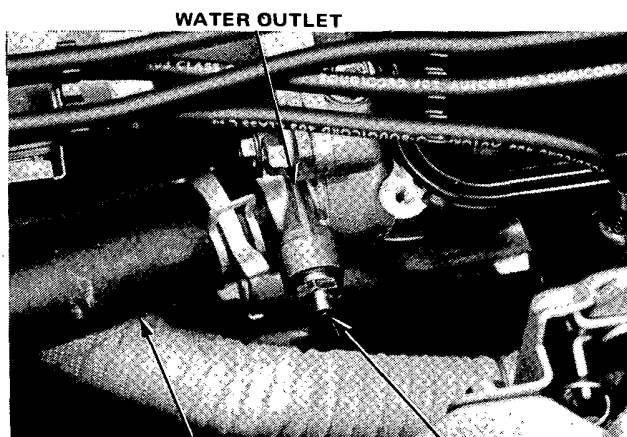

7. With the radiator cap off, start the engine and let it run until warmed up (fan goes on at least twice). Then, if necessary add more coolant mix to bring the level back up to the bottom of the filler neck.
8. Put the radiator cap on, then run the engine again and check for leaks.



Cap Testing

1. Remove the radiator cap, wet its seal with coolant, then install it on the pressure tester.
2. Apply a pressure of 0.75–1.05 kg/cm² (78–98 kPa, 11–14 psi).
3. Check for a drop in pressure.

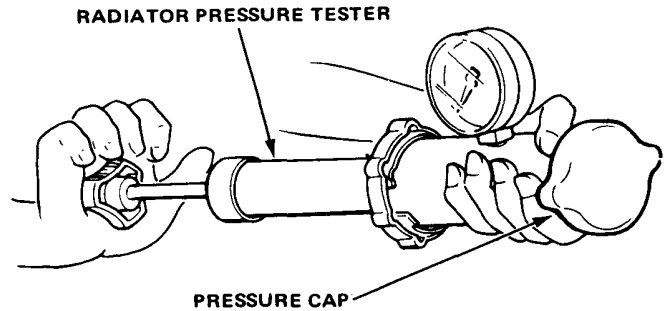

Radiator Testing

1. Wait until the engine is cool, then carefully remove the pressure cap and fill the radiator with coolant to the top of the filler neck.
2. Attach the pressure tester to the radiator and apply a pressure of 0.75–1.05 kg/cm² (78–98 kPa, 11–14 psi).
3. Inspect for coolant leaks and a drop in pressure.
4. Remove the tester and reinstall the pressure cap.

NOTE: Check for engine oil in coolant and/or coolant in engine oil.

